



MANTARAY™

Water-Propelled Polishing Tool



READ USER'S MANUAL BEFORE OPERATING

US Patent Pending, LaPlata Industries Inc.

Parts Included For Hand-Held Unit

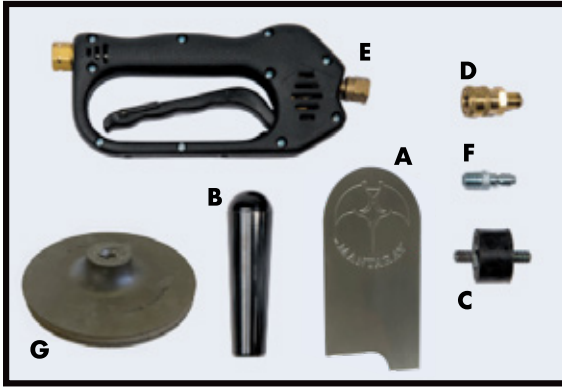

A: MantaRay Housing

B: MantaRay Side Handle

C: Vibration Mount

D: 1/4" Female Fast Connector*

E: Trigger Handle

F: 1/4" Male Connector

G: Disc



Pressure Washer
Not Included



Connector Not Included

*For best results, use a 4,000 p.s.i. pressure washer with a minimum 3.5 g.p.m

*The trigger handle fitting is not a universal fitting for all pressure washer hoses. It may require an attachment to fit your hose into the trigger handle for hand-held use.



ASSEMBLY INSTRUCTIONS

HAND-HELD UNIT FOR OUTDOOR USE ONLY

- A** Trigger Handle
- B** ¼" Male Connector
- C** ¼" Female Fast Connector
- D** MantaRay Housing
- E** Disc
- F** MantaRay Side Handle
- G** Vibration Mount
- H** ½" Wrench (Not Included)

- Ensure all fittings are tightly secured.
- Using Teflon tape (not included) for use as a sealant on all threaded surfaces.
- Check to make sure there are no leaks prior to use.
- Check for loose particles or obstructions in and around the area of operation.
- Do not wear loose clothing.
- Keep hands and feet away from all moving parts.
- Wear eye and ear protection at all times.

Secure the appropriate hook and loop disc and grit pad for the project for which the MantaRay is used. Do not use adhesive discs or grit pads. The shaft is universal and will accommodate any hook and loop discs. Using the MantaRay with the vacuum attachment requires a 7" hook and loop disc. Using the MantaRay as a hand-held tool can accommodate hook and loop discs between 3" and 7".

Ensure the MantaRay has come to a complete stop prior to removing any abrasives or discs. Handle the MantaRay with care and do not drop. **After every use, remove the disc and clean the disc threads and shaft threads. Failure to do so will void the manufacturer's warranty and/or service contract.**

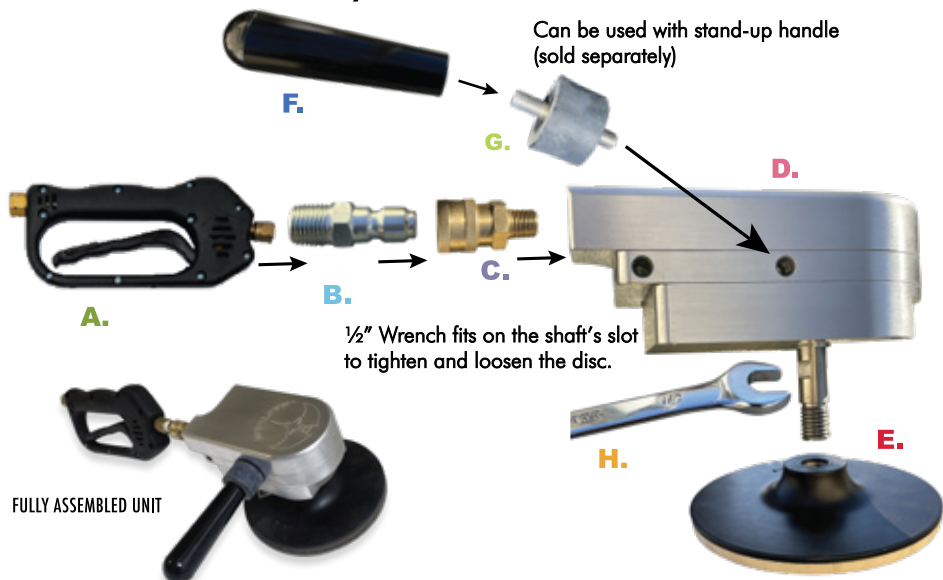

*Side handle with vibration mount can be attached to either side of unit for left-handed or right-handed use.



MADE IN THE USA

US Patent Pending, LaPlata Industries Inc.

www.MantaRayTools.com

MantaRay Water-Propelled Polishing Tool with Vacuum System

Includes MantaRay Water-Propelled Polishing Tool, MantaRay Vacuum Attachment, Standup Handle, and Optional IPC Eagle Professional Pump-Out Vacuum

*For Indoor or Outdoor Use



4,000 p.s.i. Power Washer
Not Included

Optional IPC Eagle Professional
Pump-Out Vacuum

Use the MantaRay to polish surfaces such as:

Limestone



Marble



Granite

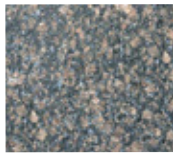

Porcelain



Glass



Terrazzo

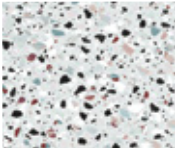

Onyx



Travertine

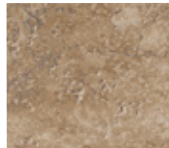

Concrete





ASSEMBLY INSTRUCTIONS

MANTARAY VACUUM SYSTEM

Parts Included With Indoor Vacuum System

- A** 3/8x16 Bolt (x4)
- B** Washers (x4)
- C** Standup Handle Pressure Hose
- D** Standup Handle
- E** Tail Spring
- F** 1/2" Nut
- G** Tail Shaft
- H** 1/4" Female Fast Connector
(Requires Teflon tape prior to connection).
- I** Plastic Spacer



MADE IN THE USA

US Patent Pending, LaPlata Industries Inc.

www.MantaRayTools.com



ASSEMBLY INSTRUCTIONS

MANTARAY VACUUM SYSTEM

To attach the MantaRay Housing to the MantaRay Vacuum Attachment:

1. Place shaft of MantaRay Housing into top hole of the MantaRay Vacuum Attachment. Press the MantaRay Housing down so it is flush with the MantaRay Vacuum Attachment. It will sit secure in the attachment.
2. Secure the MantaRay Housing to the MantaRay Vacuum Attachment by using the washers (Part B) (x2) and 3/8x16 bolts (Part A) (x2). Tightly secure the bolts into the top side holes in the MantaRay Vacuum Attachment. The bolt holes in the MantaRay Housing line up with the bolt holes in the MantaRay Vacuum Attachment.
3. Secure the Standup Handle (Part D) to the rear holes on each side of the MantaRay Housing by using the washers (Part B) (x2), 3/8x16 bolts (Part A) (x2), and plastic spacers (Part I) (x2).
4. Using Teflon tape on the threads of the 1/4" Female Fast Connector (Part H), screw Part H into the hole on the top right-hand side of the rear of the MantaRay Housing. Insert the Standup Handle Pressure Hose (Part C) into the 1/4" Female Fast Connector.
5. Screw in the Tail (Part G) into the hole in the center of the rear of the MantaRay Housing. Use a 1/2" wrench (not included) to tighten shaft or loosen.
6. Connect the Tail Spring (Part E) to the Tail Shaft (Part G) and secure with the 1/2" nut (Part F). Tighten Part F with a 1/2" wrench (not included).
7. Attach the disc by holding the MantaRay Housing shaft with 1/2" wrench (not included) through the airflow adjusting door on the side of the MantaRay Vacuum Attachment. Then tighten the disc onto the MantaRay Housing shaft.

To attach or remove the disc, you will need to use a 2M Hex Key to open the adjustable airflow door on the MantaRay Vacuum Attachment. See photo 5 on page 9.



1. Before attaching the pressure washer hose to the MantaRay, allow the water to flow from the pressure washer hose to remove any sediment, dirt, or debris from the hose. Failure to do so will void the manufacturer's warranty and/or service contract.

Attach pressure washer hose to fitting (not included). Apply Teflon tape to the fitting and then attach fitting and hose to 90-degree adapter on stand-up handle.

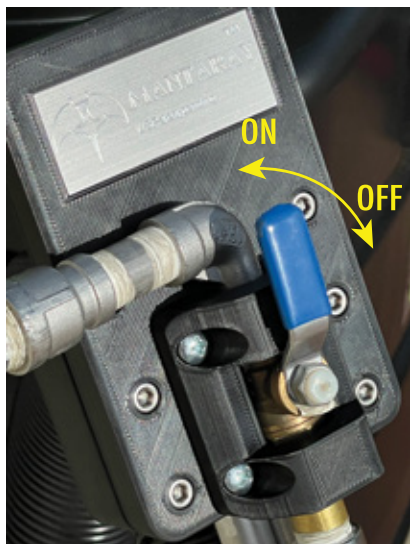

2. The valve lever allows the water to flow from the pressure washer to the MantaRay. To turn the water on, the valve lever must be in the vertical position. To turn the water off, the valve lever must be in the horizontal position. The valve lever must be in the on position to operate the MantaRay.

- 3.** To attach the IPC Eagle Pump-Out Vacuum hose to the stand-up handle, detach the hose clamp by using a $5/32''$ Hex Key (not included) to remove the 10-32 screws (2). Insert the vacuum hose into the hose clamp and re-attach the bottom clamp and tighten the 10-32 screws with the $5/32''$ Hex Key.

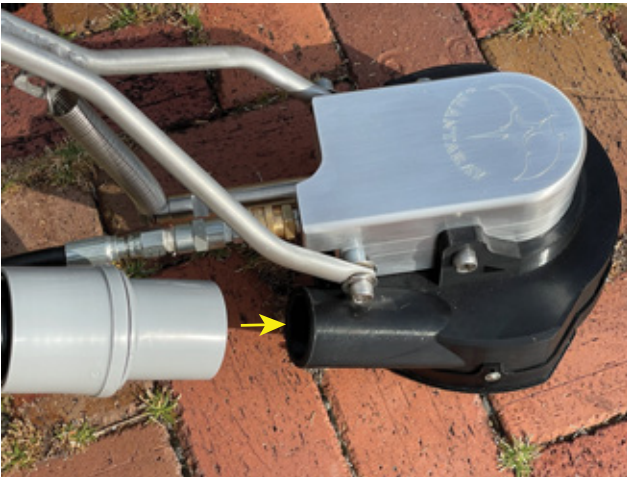

- 4.** Securely attach the 2" IPC Eagle Professional Pump-Out Vacuum Hose to the vacuum attachment port.



- 5.** The MantaRay Vacuum Attachment has an adjustable door to control the airflow to the until. When using the MantaRay Vacuum Attachment with the Optional IPC Eagle Professional Pump-Out Vacuum, the adjustable door should be secured in the closed position. To secure, use a 2M Hex Key (included) to tighten the screw directly above the center of the adjustable door.

If not using the Optional IPC Eagle Professional Pump-Out Vacuum, and more airflow is required, use the 2M Hex Key to loosen the screw above the center of the adjustable door and adjust the door to the proper amount of airflow and then tighten the screw to secure the adjustable door.

If the MantaRay is not moving freely across the floor, the airflow should be increased and the adjustable airflow door should be opened more. If water is flowing from underneath the MantaRay Vacuum Attachment, the airflow should be decreased and the adjustable airflow door should be opened less.

- 6.** The MantaRay Vacuum Attachment should be flush with the flooring surface. After the disc has been installed on the MantaRay, place the MantaRay Vacuum Attachment on the project surface. Using a 2M Hex Key (included), loosen the skirt screws around the bottom of the MantaRay Vacuum Attachment. Adjust the skirt of the MantaRay Vacuum Attachment so it is flush with the project surface. After it is flush with the surface, tighten the screws to secure the skirt of the MantaRay Vacuum Attachment.

The skirt must be flush with the project surface in order to operate properly.



Warranties and Repairs

The MantaRay is proudly manufactured by La Plata Industries, Inc. in South Florida and is warranted against defects in materials or workmanship under the intended use of the MantaRay. La Plata Industries, Inc. is not responsible for personal or property damage or product damage caused by misuse, operator negligence, dropping of the MantaRay, or use in any manner not intended.

An optional 2-year service contract is available through La Plata Industries, Inc., manufacturer of the MantaRay. For information on the optional service contract, contact your La Plata Industries, Inc. sales representative at (954) 464-7570 or return the enclosed card with your payment to
La Plata Industries, Inc.

Thank you for your purchase.



Copyright 2022 La Plata Industries Inc.

www.MantaRayTools.com



**4848 NE 11th Avenue
Oakland Park, FL 33334
www.MantaRayTools.com**